

E

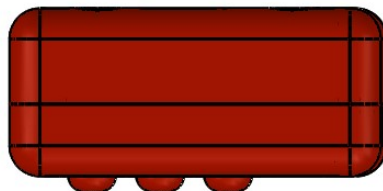

E



D

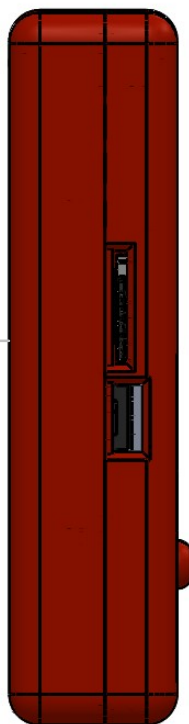

D

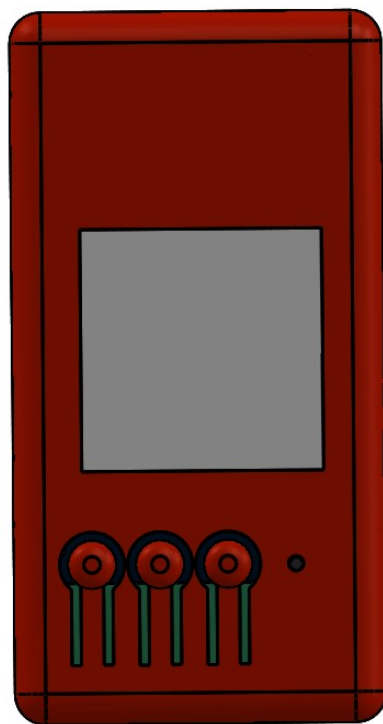

C

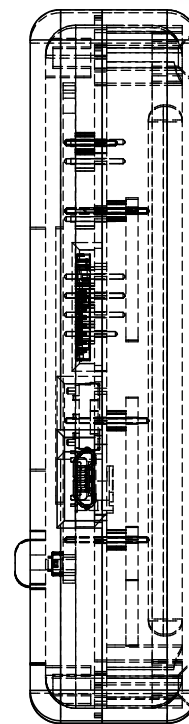

C

B

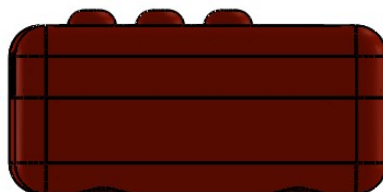

B

SAUF INDICATION CONTRAIRE: LES COTES SONT EN MILLIMETRES ETAT DE SURFACE: TOLERANCES: LINEAIRES: ANGULAIRES:			FINITION:			CASSER LES ANGLES VIFS		NE PAS CHANGER L'ECHELLE		REVISION	

NOM		SIGNATURE		DATE				TITRE:	